

BMC

17.4Ø x 42 mm

Ideal for use in electric vehicles charging protection boards



Agency Approvals

Agency	Ampere Rating
Recognized Component for Canada and US	25A - 180A
CCC	50A - 180A

Interrupting Rating

160,000 amperes at 240V AC
50,000 amperes at 150V DC

Catalog Number	Ampere Rating (A)	Voltage Rating (V)	Nominal Cold Resistance (Ohms)	Watts Loss 100% In (W)	Clearing at 240V I ² t (A ² sec.)
BMC 050	50A	240V	0.00183	8.800	2463.00
BMC 060	60A		0.00156	11.00	3574.30
BMC 070	70A		0.00117	12.50	4047.00
BMC 080	80A		0.00098	13.70	5447.00
BMC 100	100A		0.00072	16.20	8352.00
BMC 125	125A		0.00060	22.00	10077.0
BMC 150	150A		0.00049	25.00	15100.0
BMC 180	180A		0.00038	25.00	17268.0

Product Characteristics

Operating Temperature	-55 °C to 125 °C
Material	Body: Ceramic / Caps: Tin Plated Copper Alloy / Terminal: Tin Plated Copper

Mechanical Dimensions(mm)

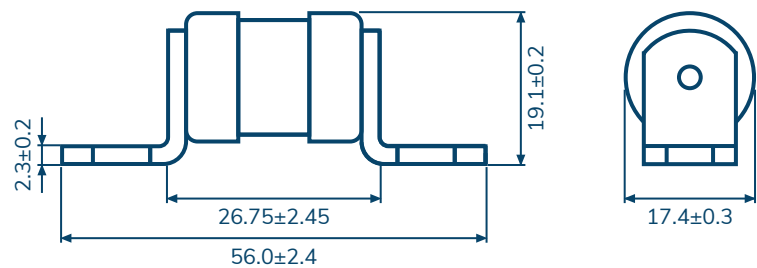

Packaging

Packaging Option	Quantity
Bulk	10 pcs / box

